



Our goal is to make the American
inner city better.

urbanpatch.org | [@urbanpatchorg](https://twitter.com/urbanpatchorg)



Urban Patch has a simple but powerful mission, to help make the American inner city better. Our work uses what we call a “past forward” approach that brings the rich legacy of our community’s past in building strong and resilient neighborhoods forward to today and the future by using holistic models of social, environmental and economic community development. Our projects have ranged from saving long-abandoned and foreclosed homes in the inner city to turning vacant lots into community spaces that can provide fresh and healthy food or ecological benefits, and to education programs that teach people how to take care of their families’ health, improve their community and steward their urban environment.



MID-NORTH LAND USE AND VACANCY PATTERNS

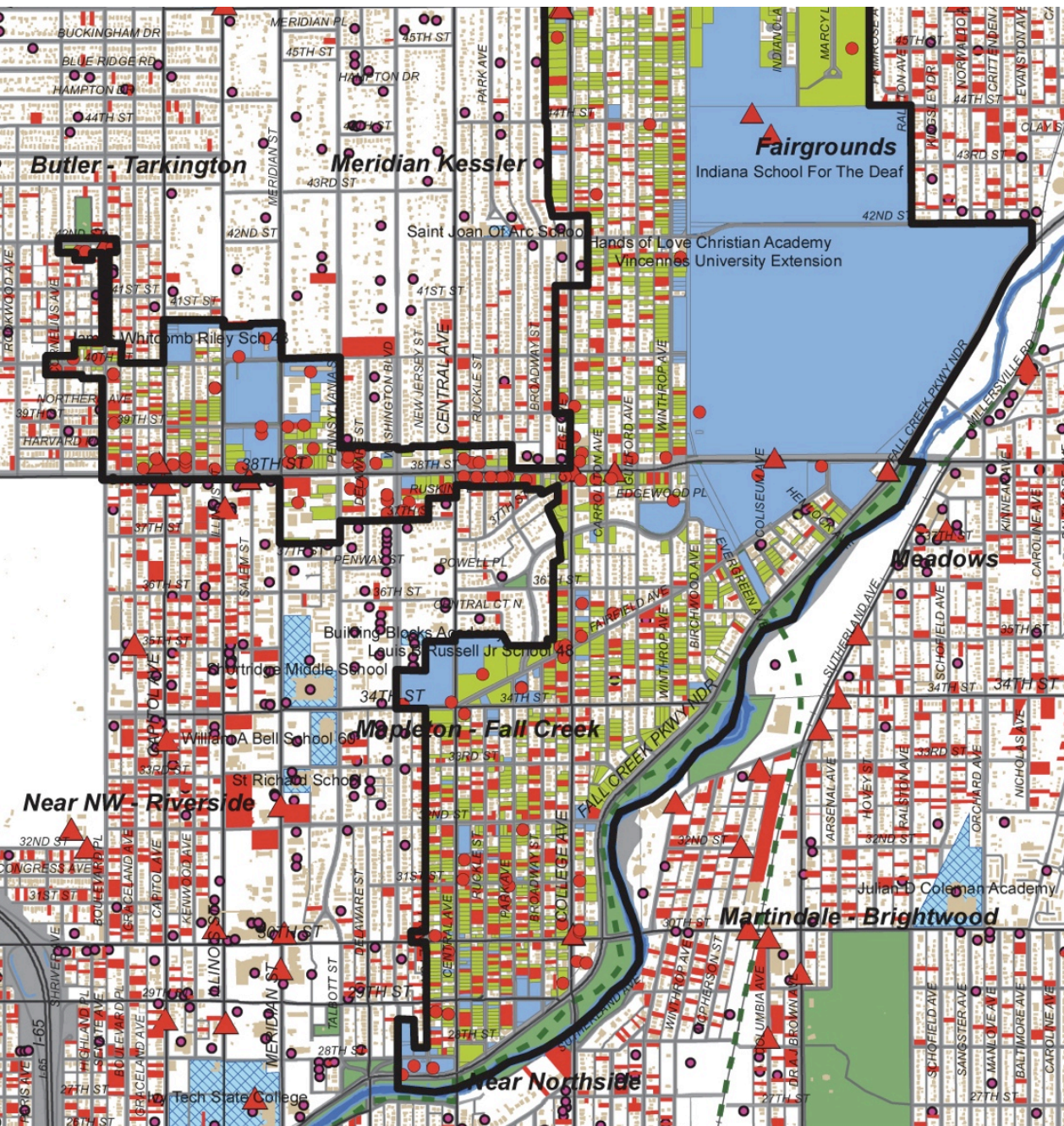

LAND USE

VACANT:
397 Parcels = 50 Acres

PUBLIC OR NOT-FOR-PROFIT:
234 Parcels = 526 Acres

PARCELS WITH LOWER ASSESSMENTS
(Valued at less than \$500,000 per Acre)
= 1617 Parcels = 364 Acres
(Public Property not included)

ZONING VARIANCES:
592 Cases = 365 Parcels = 405 Acres

VACANT ADDRESSES :
(Jan2011_USPS) = 561 Parcels = 79 Acres

BROWNFIELDS: 35 Parcels =
320 Acres (Fair Grounds Included)

Source: Indianapolis Dept.
of Metropolitan
Development

Phase 1: projects are within walking distance

HISTORIC MERIDIAN PARK - DELAWARE PROJECT
foreclosure home rehabilitation



FALL CREEK GARDENS - STONE SOUP GARDEN
1 acre community garden

MFC - PARK GARDEN
5200 sf permaculture garden



DELAWARE PROJECT

HISTORIC MERIDIAN PARK

DELAWARE PROJECT

HISTORIC MERIDIAN PARK



COLLABORATION W/ FALL CREEK GARDENS

MAPLETON FALL CREEK



Support and programming for a 1-acre community garden

COLLABORATION W/ FALL CREEK GARDENS

MAPLETON FALL CREEK



Sunflower mural project with volunteer students from Shortridge High School

PARK GARDEN



Volunteers helping install the garden (during a drought!)

PARK GARDEN



The project created a new permaculture green space providing fresh fruit, herbs & flowers for the community.

STONE SOUP KITCHEN



OUR PARTNERS

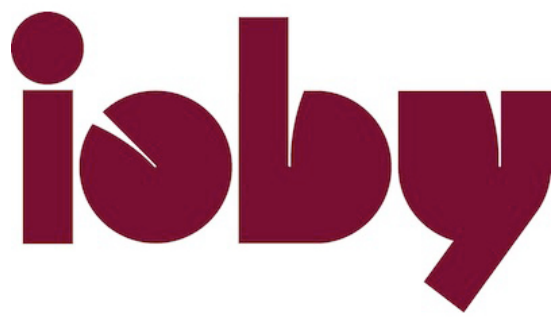

CROWDFUNDING/RESOURCING



ioby brings environmental projects to life, block by block.





[see our progress](#)

[get started »](#)

STATUS: UNDERWAY, ACCEPTING VOLUNTEERS

Urban Patch - Park Garden

The Park Garden is a new green space on Indianapolis' north side. It will be a permaculture garden with fruit trees and bushes, and native plant species.

SHARE THIS PROJECT    

[OVERVIEW](#) [BUDGET](#) [UPDATES](#) [DONORS](#)

[NEARBY PROJECTS](#)

TOTAL FUNDING NEEDED: **\$1,326**



project leader
Urban Patch

location
3002 Park Avenue
(Mapleton - Fall Creek / North Midtown)

latest update 
Your donation in action!

\$1,341
RAISED SO FAR

\$0
STILL NEEDED

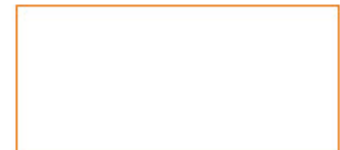

[donate to this project](#)



We use social media and crowdfunding campaigns to support our projects, programming and to get new volunteers.

ENGAGEMENT



IDEAS

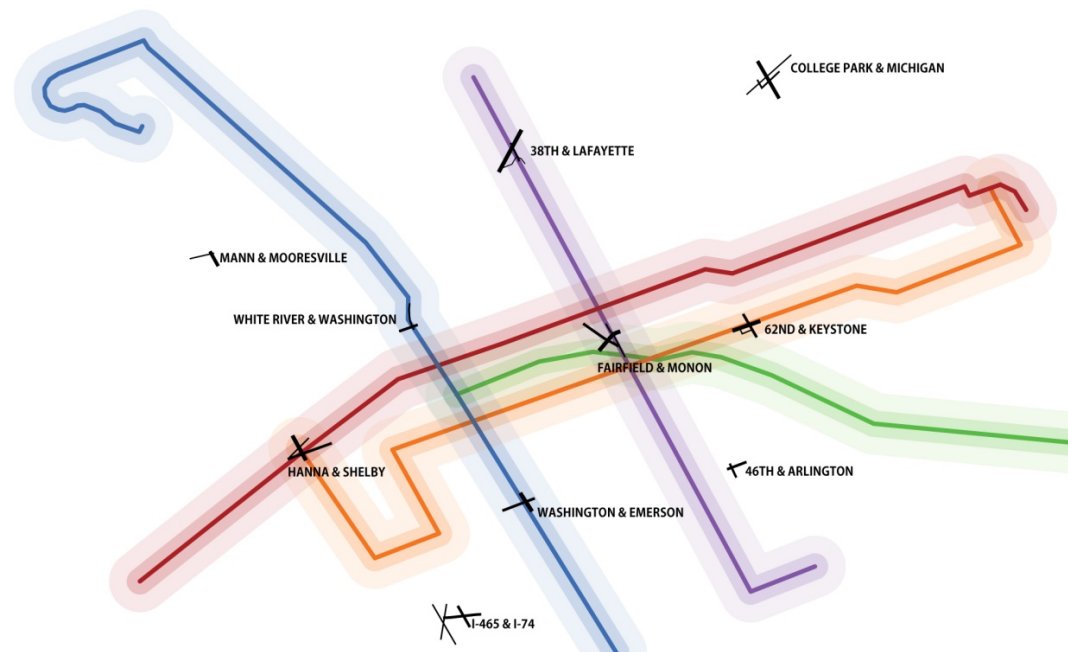

Indy Redbud Project



Indy Redbud Project: IndyHub 5x5 Grant Winner



image credit: IndyHub 5x5

Indy Redbud Project: S

Indianapolis DMD's map of vacant lots



City-owned lots at 31st and Ruckle in Mapleton Fall Creek

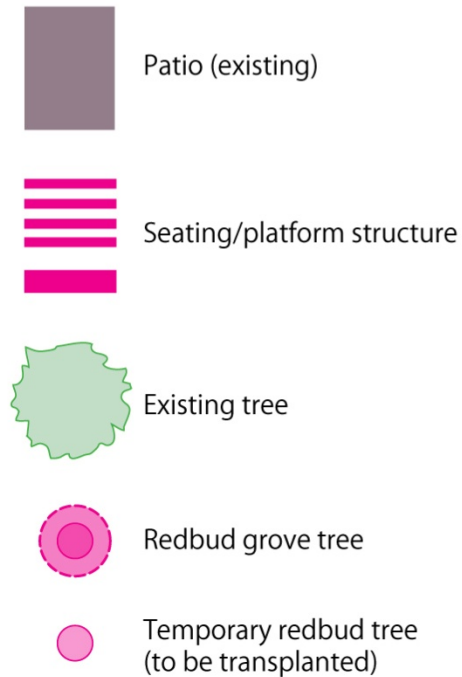

Indy Redbud Project: M

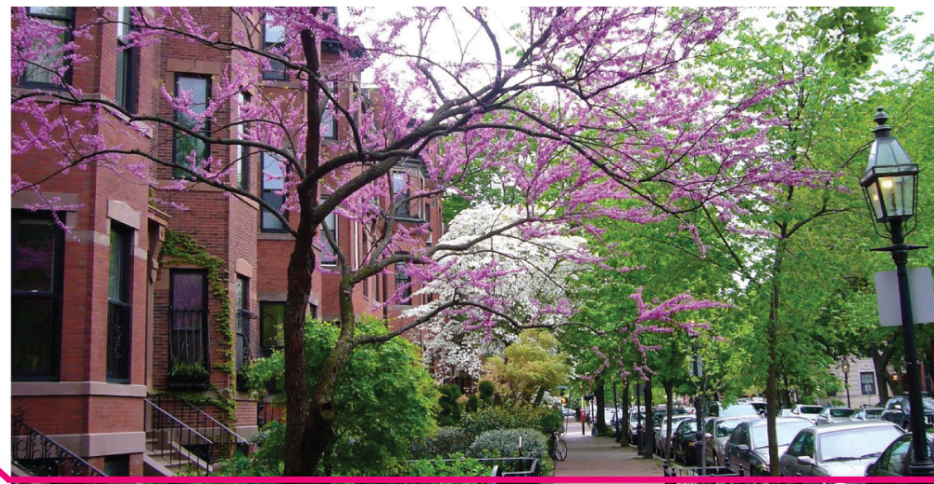
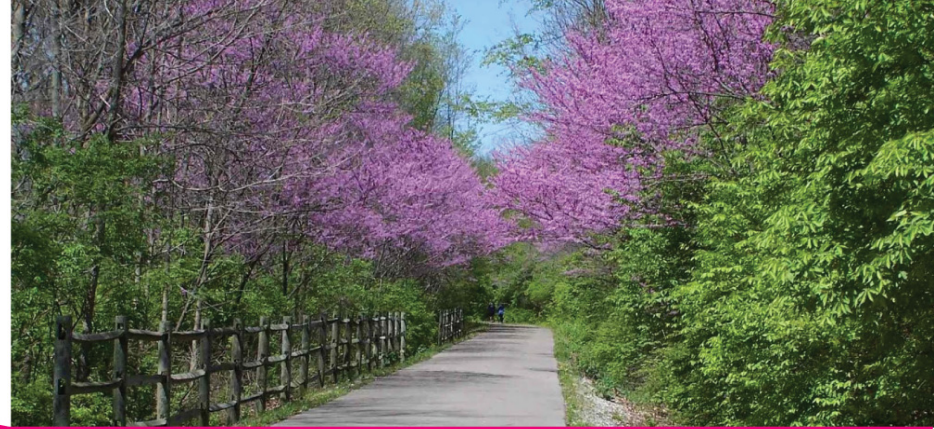
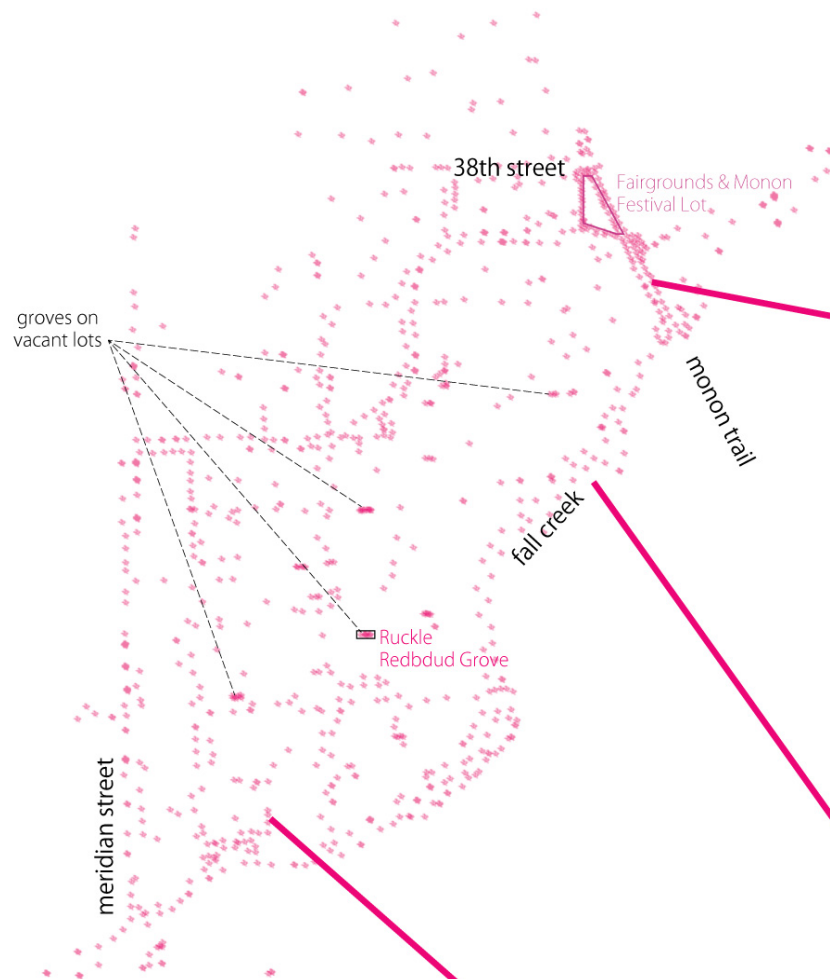

The IRP creates new urban tree canopy that improves the environment and bolsters community identity.

Indy Redbud Project: L

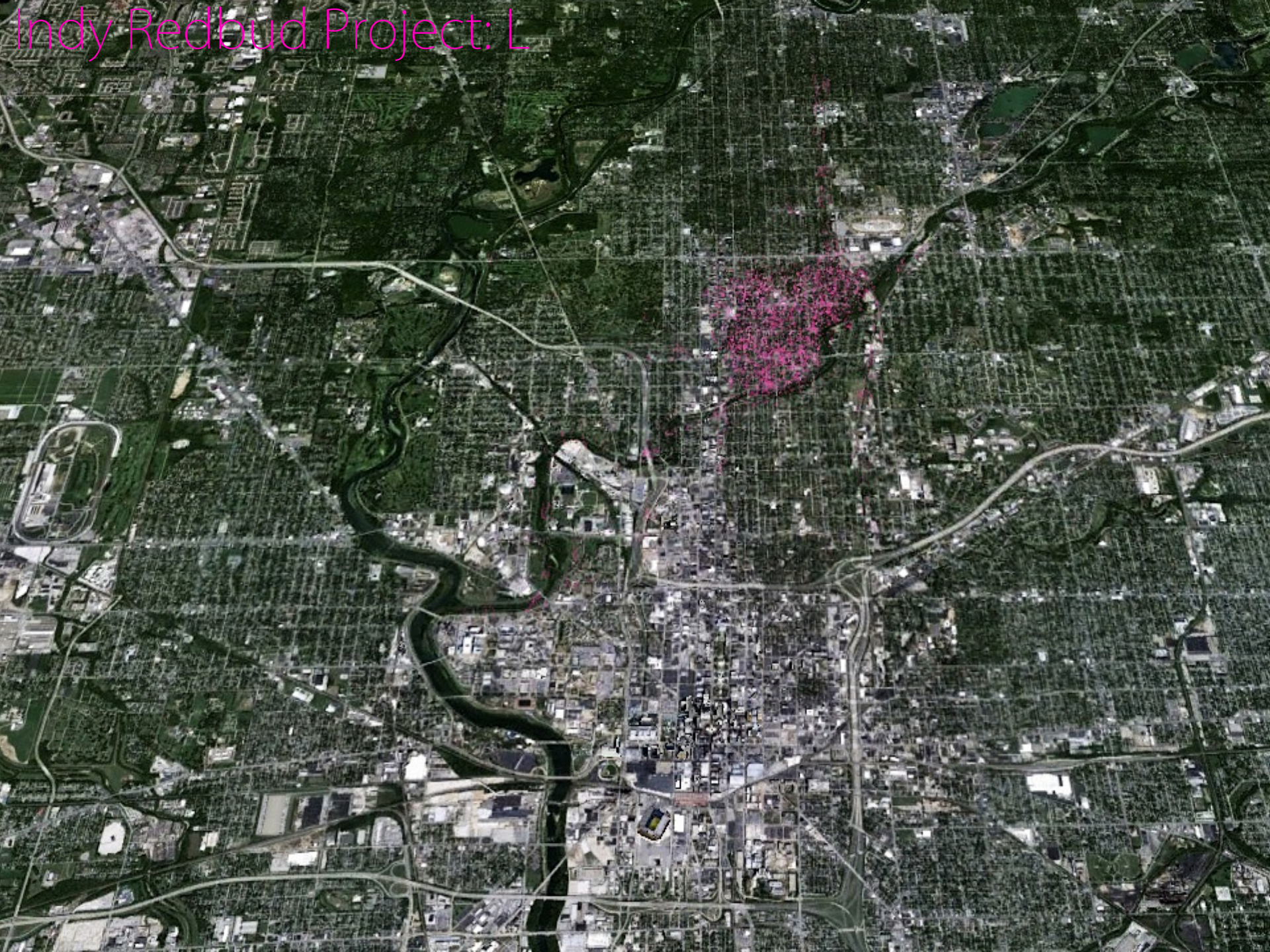

Indy Redbud Project: L

WE
INDY



The Indy Redbud Project is a community identity and environmental art initiative that over time will help to unify our neighborhoods and restore the urban tree canopy with redbuds and other shade trees.

Share Your Love for Indy with Redbuds

HELP US TO HELP INDY BLOOM !

Name

Email

Phone

Street

Message



WHAT IS IT ABOUT? About people. About their needs. Their abilities. The land they live on. The land they till. The food they grow. About the cities they live in. About the jobs they do. How they do them. And about the houses in which they live. About what people know. And don't know. And what they ought to know. Ought to know to help make America still greater.

- Flanner House *New Frontier* Plan

CONTACT US.

Joyce L. Moore: joyce@urbanpatch.org
317.513.8744

Urban Patch: urbanpatch.org
twitter: @UrbanPatchOrg

Indy Redbud Project: indyredbud.org
twitter: @IndyRedbud